

REV	DATE	ECO NO	BY
0	Sep 29 2000	ERN00122	R.S

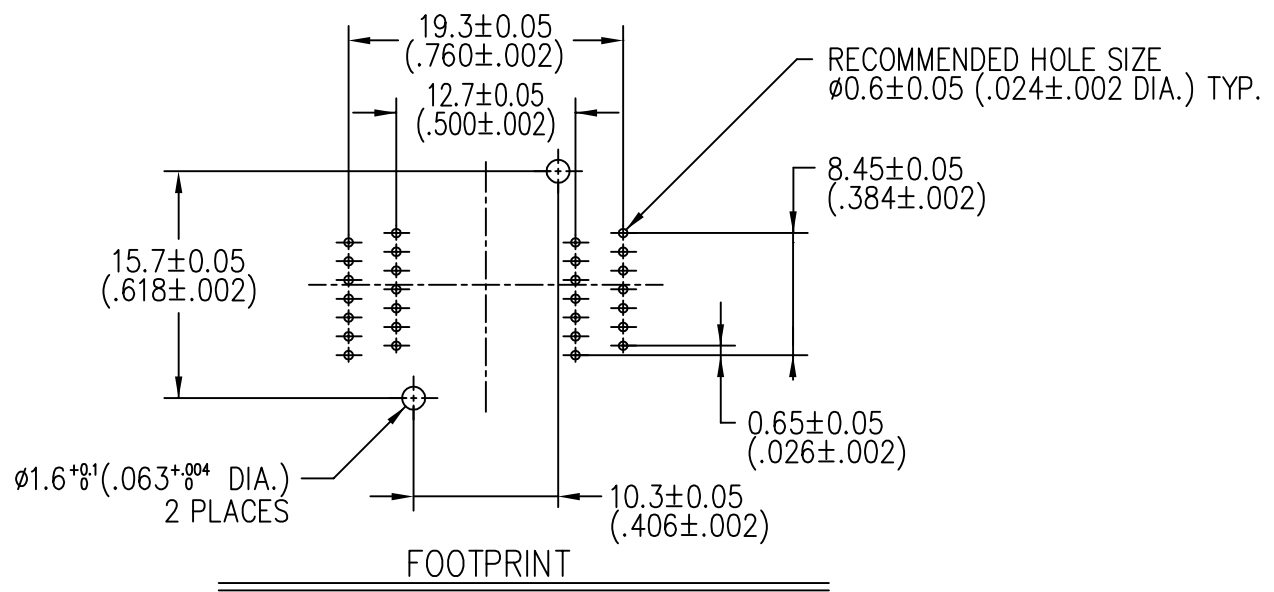
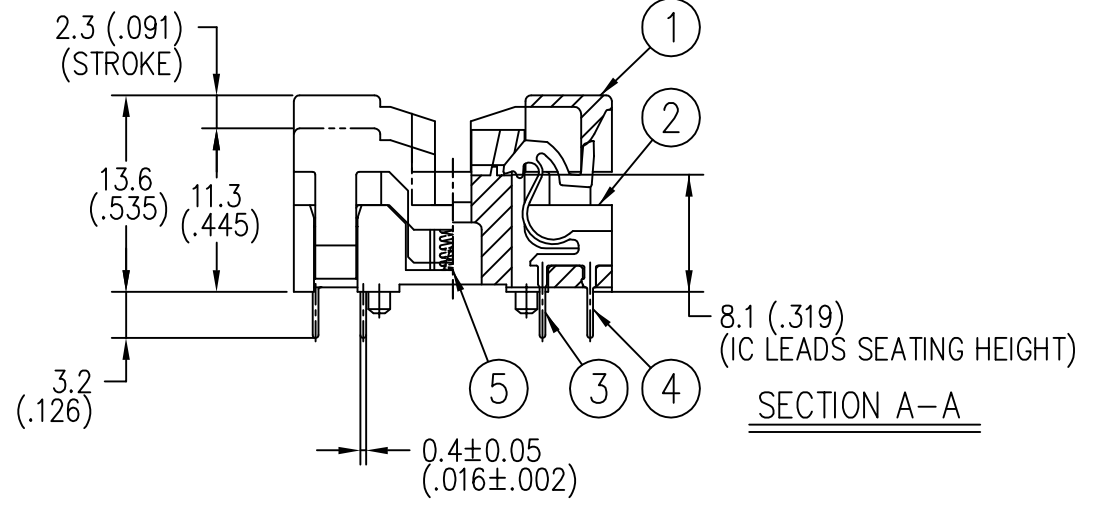
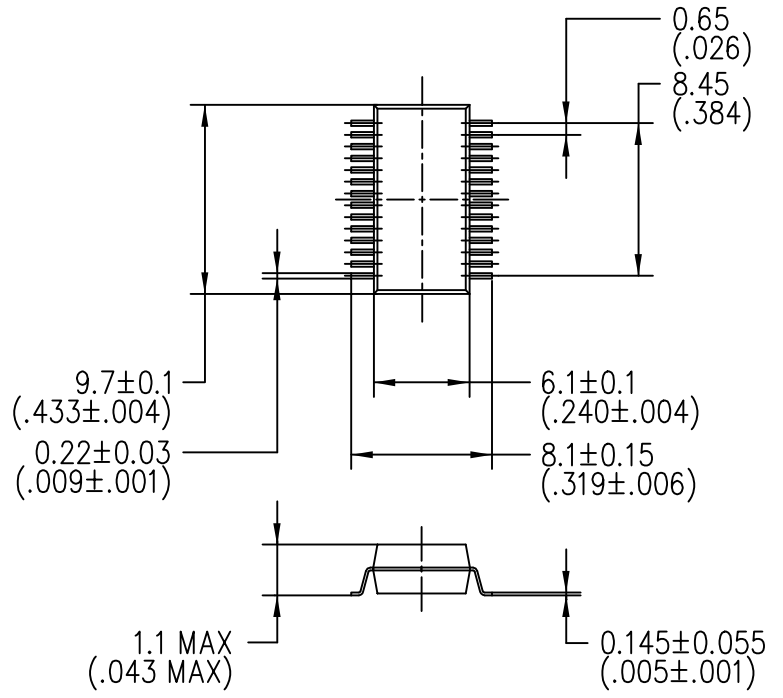
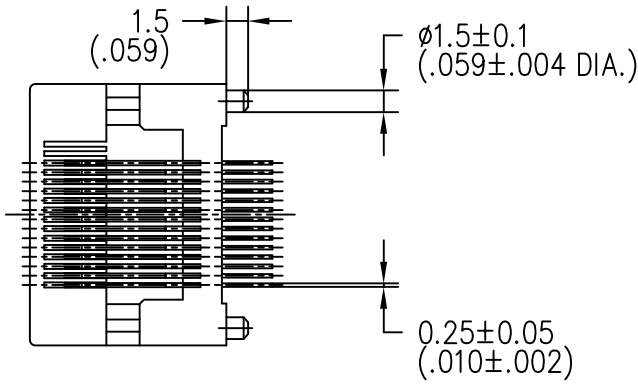
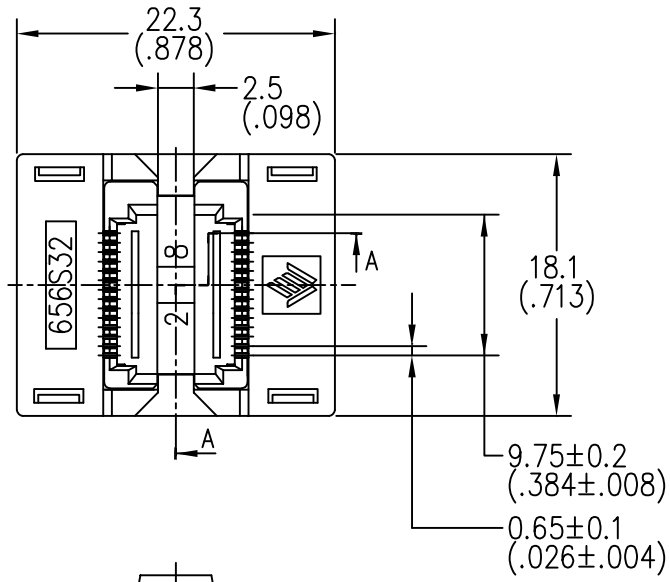

P.NO	PART DESCRIPTION	MATERIAL	QTY	NOTE
⑤	SPRING	SUS	2	
④	CONTACT-(2)	Be Cu	14	PLATING : Au
③	CONTACT-(1)	Be Cu	14	PLATING : Au
②	BASE-28P	PEI	1	COLOR : BLACK
①	COVER-28P	PEI	1	COLOR : BLACK

THIS DOCUMENT CONTAINS PROPRIETARY DESIGNS, SPECIFICATIONS, DATA, INFORMATION AND TECHNICAL MATERIAL THAT ARE THE SOLE PROPERTY OF WELLS-CTI. THIS INFORMATION IS TO BE HELD AND TREATED BY ITS RECIPIENT ON A CONFIDENTIAL BASIS, AND IS NOT TO BE SHOWN OR DISCLOSED TO THIRD PART WITHOUT THE WRITTEN CONSENT OF WELLS-CTI. THIS DATA DOES NOT CONVEY MANUFACTURING RIGHTS TO ANY ITEMS SHOW.

この図面に含まれる技術情報の一部は WELLS-CTI 単独の所有権を有する。従って情報非開示の原則に基づき WELLS-CTI 社の書面による同意無しにこの図面を第三者に開示すること及び製造目的に使用することを禁ずる。

GENERAL TOLERANCES		
±0.3 [±0.12]		
UNIT	SCALE	ANGLE
mm [in.]	2X	3rd.
DRAWN	/	/
ENGINEER	/	/
CHECKED	/	/
APPROVED	/	/

WELLS-CTI YOKOHAMA KANAGAWA JAPAN
A subsidiary of PCD Inc.

ウエルズ・シーティアイ株式会社

PART NAME
TSSOP 28P 0.65mm pitch SOCKET

PART NUMBER
656S1322811

DWG NUMBER
656MSA007

REV
0

SHEET
1/1