

# SLHNNWW629T2

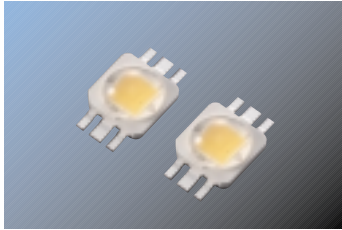

Radiation Diagram(120°)

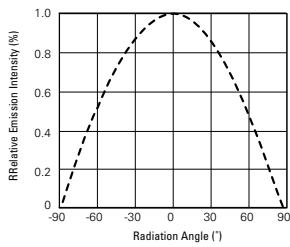

Package Outline

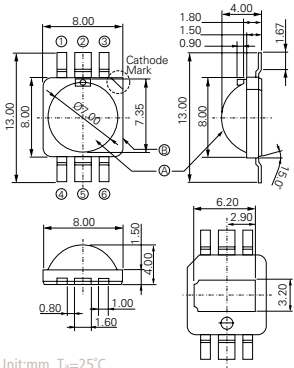

Unit:mm, T<sub>s</sub>=25°C

Polarity

Recommended Soldering Pattern

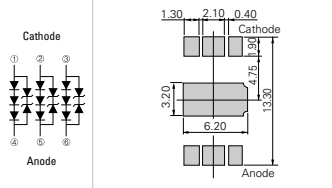

Carrier Tape

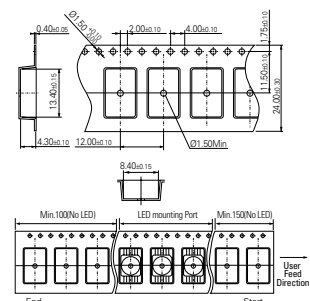

Unit:mm, T<sub>s</sub>=25°C

### Absolute Maximum Ratings

Item	I <sub>F</sub> (mA)	T <sub>J</sub> (°C)	T <sub>Stg</sub> (°C)	T <sub>Sld</sub>	T <sub>Opr</sub>
Value2	180	120	-40 ~ 110	260°C, 10sec	-40 ~ 85

T<sub>s</sub>=25°C

### Electrical Characteristics

Item	Symbol	Condition	Min.	Typ.	Max.	Unit
Forward Voltage	V <sub>F</sub>	I <sub>F</sub> =180mA	8.9	9.7	11.0	V
Reverse Voltage	V <sub>R</sub>	I <sub>F</sub> =10mA	12.0	-	16.5	

※ Tolerance : V<sub>F</sub> ±0.1V

### Chromaticity Coordinate

Rank	CCx				CCy				CCT
S0	0.3428	0.3700	0.3863	0.3471	0.3138	0.3322	0.4050	0.3818	4,000~5,000
T0	0.3700	0.4370	0.3863	0.3700	0.3322	0.3551	0.4310	0.4050	3,300~4,000
U0	0.4041	0.4440	0.4880	0.4370	0.3551	0.3700	0.4490	0.4310	2,600~3,300

T<sub>s</sub>=25°C, @180mA

※ Tolerance: x,y ±0.02

Part Number	Dimension (mm)	Rank	Luminous Flux (lm)			Condition	CRI	Viewing Angle 2θ 1/2(degree)
			Min.	Typ.	Max.			
SLHNNWW629T2	8.0×8.0×3.9t	S2	100	135*	180	180mA	80	120°

※ Tolerance ±10%  
 ※ 125lm @ 2,600 - 3,200K

Relative Luminous Flux vs Forward Current

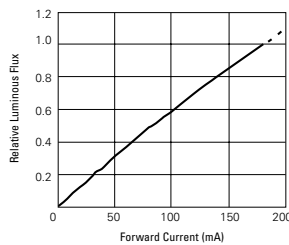

Forward Current vs. Forward Voltage

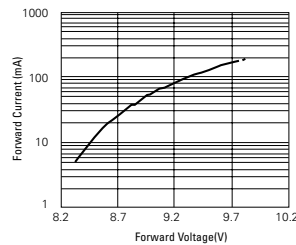

Spectrum Distribution

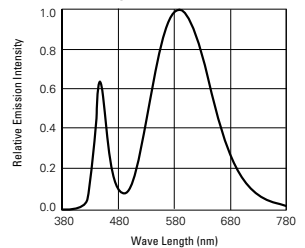

Derating Curve for 120mA

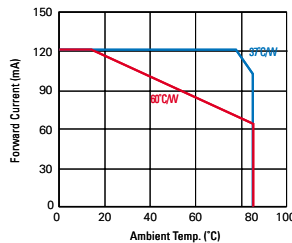

Derating Curve for 180mA

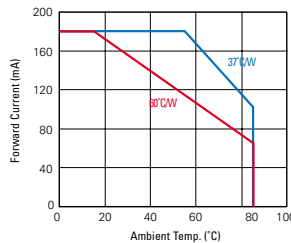

CIE Coordinate

