

8 7 6 5 4 3 2 1

REVISIONS				
REV	ECN	DESCRIPTION	DATE	BY
A1	06-0456	INITIAL RELEASE	7/13/2006	SH

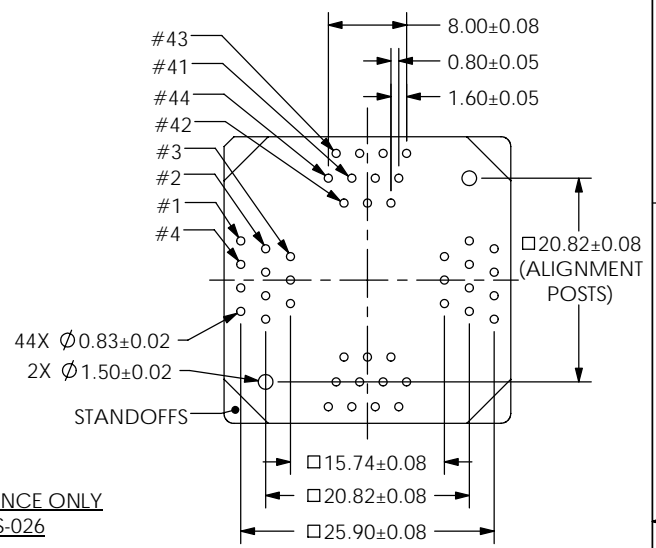
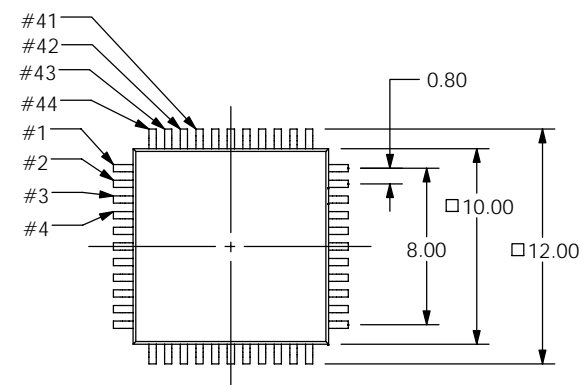
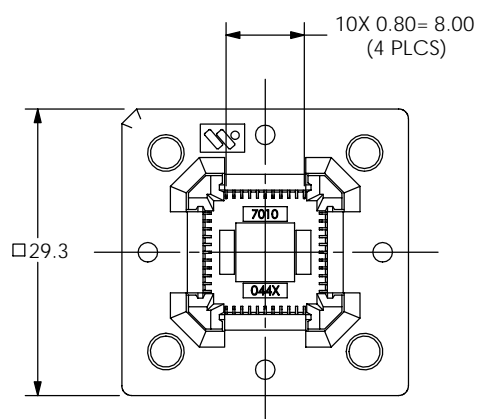

ALL PACKAGE DIMENSIONS ARE FOR REFERENCE ONLY
PACKAGE SPECIFICATION IS JEDEC MS-026

PCB HOLE PATTERN LAYOUT
(TOP VIEW)

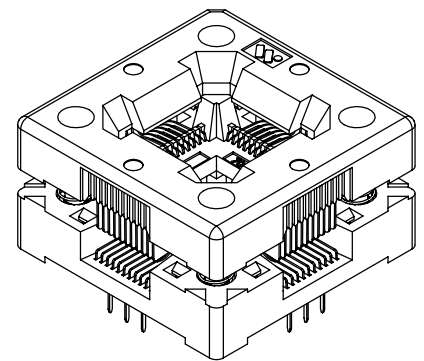
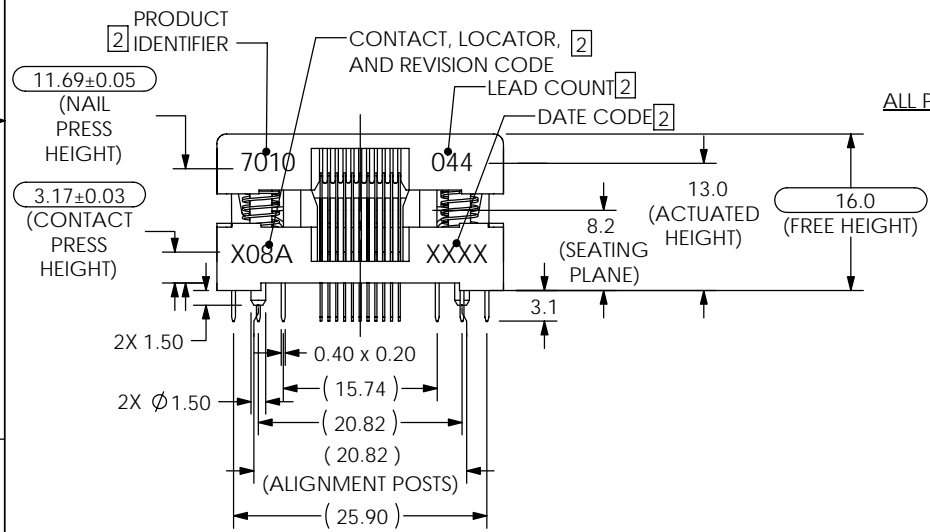

7010-044 - X - 08 A SOCKET ASSEMBLY REVISION

CONTACT MATERIAL & PLATING
 0 = BeCu w/ Au (Overall) (SPECIAL ORDER)
 3 = Pfin w/ Au Overall (SPECIAL ORDER)
 6 = BeCu w/ Au-Au FLASH
 7 = Pfin w/ Au-Au FLASH (SPECIAL ORDER)

2 MARKING: 2.0 HIGH, COLOR - WHITE.
 1. MATERIAL AND FINISH:
 SOCKET LID AND BASE - POLYETHERIMIDE OR EQUIVALENT
 CONTACTS - SEE CHART.
 SPRINGS AND NAILS - STAINLESS STEEL, PASSIVATED.
 NOTES:

LEGEND		INTERPRET DRAWING IN ACCORDANCE WITH ASME Y14.5M-1994		MATERIAL FINISH		Advanced Test Technologies Phoenix, Arizona USA	
3	TOTAL NO. OF USED	TOLERANCES XX ± 0.2 X.XX ± 0.08 X.XXX ± 0.025 ANGLE ± 1°		REFERENCE	DRAWN SH	DATE 07/12/2006	TITLE TOFP SOCKET ASSEMBLY (10mm, 44ld.)
PROJECTION		PROJECT / SERIES		CHECKED	ENGINEER PH	DATE 03/29/2001	DRAWING NUMBER 7010-044-X-08
SIZE B		CONFIDENTIAL/PROPRIETARY THIS DOCUMENT CONTAINS PROPRIETARY INFORMATION OF UMD/WELLS-CTI. NOT TO BE USED, COPIED OR DISCLOSED WITHOUT PERMISSION. ALL RIGHTS RESERVED.		QUALITY	DATE	SCALE 2:1	UNITS:mm [in]
				MFG. ENGR.	DATE	DO NOT SCALE	SHEET 1 OF 1
						REV. A1	

8 7 6 5 4 3 2 1