

Single Ended Load Beam



FEATURES

- Capacities: 0.5, 1, 2, and 5 tons
- Fully welded, stainless steel construction
- Hermetically sealed, IP66 and IP68
- Certified to OIML R-60, 4000d and NTEP 10000d
- Current calibration output (SC version) ensures easy and accurate parallel connection of multiple load cells
- Digital version available (model SBC)

OPTIONAL FEATURE

- ATEX- EEx ib IIC T6 hazardous area approval
- FM approval available



DESCRIPTION

The SSB is a stainless steel single ended shear beam type load cell.

This robust product is suitable for a wide range of platform scales, pallet scales, overhead track scales and process weighing applications.

The fully welded construction and water block cable entry ensure that this product can be

used successfully in harsh environments found in the food, chemical and allied process industries.

This product meets the stringent Weights and Measures requirements throughout Europe and the USA.

APPLICATIONS

- Platform scales
- Belt scales
- Pallet scales
- Overhead track scales
- On-board weighing
- Silo hopper weighing

OUTLINE DIMENSIONS in millimeters

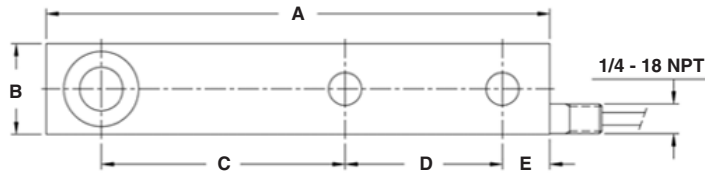

Note: Dimensions in millimeters

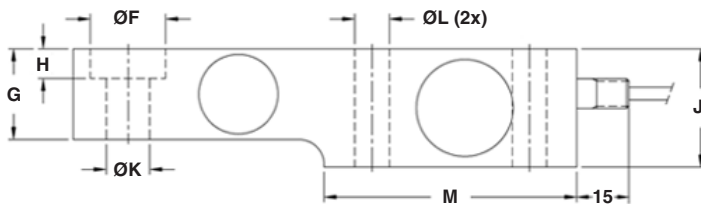

Cable specifications:

Cable length: 5 meters

Excitation + Green

Excitation - Black

Output + White

Output - Red

Shield Transparent

Capacity (kg)	500 - 2000	5000
A	203.2	235.0
B	36.5	47.5
C	98.4	123.8
D	63.5	66.7
E	19.1	20.6
F	30.2 ^{+0.2} ₀	41.3 ^{+0.2} ₀
G	36.5	47.6
H	11.9	15.8
J	47.6	69.9
K	17.5 H11	25.5 H11
L	14.0	22.0
M	101.6	111.2

**SPECIFICATIONS**

PARAMETER	VALUE					UNIT
	0.5, 1, 2, 5*			2, 5*		
Standard capacities (E_{max})						t
Accuracy class according to OIML R-60	NTEP IIII	Non-Approved	C3	C3MI8	C4	
Max. no. of verification intervals	10000		3000	3000	4000	
Min. verification interval ($V_{min}=E_{max}/Y$)			$E_{max}/10,000$	$E_{max}/15,000$	$E_{max}/10,000$	
MDLOR ($Z=E_{max}/2*DR$)			--	8000	--	
Min. verification interval, type MR			$E_{max}/20,000$		$E_{max}/20,000$	
Rated output (=S)	2					mV/V
Rated output tolerance	0.02					±mV/V
Zero balance	1.0					±% FSO
Combined error	0.0200	0.0500	0.0200	0.0200	0.0170	±% FSO
Non-repeatability	0.0100	0.0200	0.0100	0.0100	0.0090	±% FSO
Minimum dead load output return	0.0250	0.0500	0.0167	0.0063	0.0125	±% applied load
Creep error (30 minutes)		0.0600	0.0245	0.0245	0.0184	±% applied load
Creep error (20 minutes)	0.030	0.0200	0.0053	0.0053	0.0039	±% applied load
Temp. effect on min. dead load output	(0.001)	0.0250	0.0070	0.0050	0.0070	±% FSO/5°C (°F)
Temp. effect on min. dead load output, type MR			0.0035		0.0035	±% FSO/5°C
Temperature effect on sensitivity	(0.0008)	0.0250	0.0050	0.0050	0.0045	±% applied load/5°C (°F)
Minimum dead load	0					% E_{max}
Maximum safe over load	150					% E_{max}
Ultimate over load	300					% E_{max}
Maximum safe side load	100					% E_{max}
Deflection at E_{max}	0.5 max.					mm
Excitation voltage	5 to 15					V
Maximum excitation voltage	18					V
Input resistance	350±3.5					Ω
Output resistance	350±3.5					Ω
Insulation resistance	≥5000					MΩ
Compensated temperature range	-10 to +40					°C
Operating temperature range	-40 to +80					°C
Storage temperature range	-40 to +90					°C
Element material	Stainless steel 1.4542					
Sealing (DIN 40.050 / EN60.529)	IP66 & IP68					
SC-Version (current calibration)	Standard					
Recommended torque on fixation bolts	0.5-2t: 110 / 5t: 540					N*m

* for 10 ton capacity please consult factory

FSO-Full Scale Output

SC-version: The rated output and the output resistance are balanced in such a way, that the output current is calibrated to within 0.05% of a reference value. This allows easy parallel connection of the load cells.

VISHAY TRANSDUCERS (VT) SALES OFFICES

VT Americas
City of Industry, CA
PH: +1-626-858-8899
FAX: +1-626-332-3418
vt.us@vishaymg.com

VT Netherlands
Breda
PH: +31-76-548-0700
FAX: +31-76-541-2854
vt.nl@vishaymg.com

VMG UK
Basingstoke
PH: +44-125-646-2131
FAX: +44-125-647-1441
vt.uk@vishaymg.com

VMG Israel
Netanya
PH: +972-9-863-8888
FAX: +972-9-863-8800
vt.il@vishaymg.com

VMG Germany
Heilbronn
PH: +49-7131-3901-260
FAX: +49-7131-3901-2666
vt.de@vishaymg.com

VT China
Tianjin
PH: +86-22-2835-3503
FAX: +86-22-2835-7261
vt.prc@vishaymg.com

VMG France
Chartres
PH: +33-2-37-33-31-20
FAX: +33-2-37-33-31-29
vt.fr@vishaymg.com

VT Taiwan*
Taipei
PH: +886-2-2696-0168
FAX: +886-2-2696-4965
vt.roc@vishaymg.com
*Asia except China